

NO	件號 PAT. NO	名稱 NAME	材質 MATL	件數 SH#	處理 TREAT	備註 REMARK
1	B-317ZN-R	本體 BODY	Zn ALLOY	1	M-Ni	—
2	M-1602-PB-R	半月邊 CLAMP	Zn ALLOY	1	M-Ni	—
3	M-1602-PC-R	固定帽 CAP	COPPER ALLOY	1	M-Ni	—
4	M-1605-PA-R	導梢 CONTACT	PBb	5	M-Ni	—
5	M-1605-PB-R	電木座 INSULATOR	BAKELITTE	1	—	—
6	M-1602-PF-R	圓頭螺絲 SCREW	IRON	2	M-Ni	—
7	M-1602-PG-R	埋頭螺絲 SCREW	IRON	1	M-Ni	—
8	M-1602-PH-R	塑膠管 PIPE	PE	1	—	—

智慧財產權 請勿抄襲盜用

本產品符合 ROHS 指令

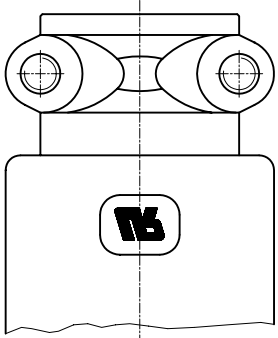
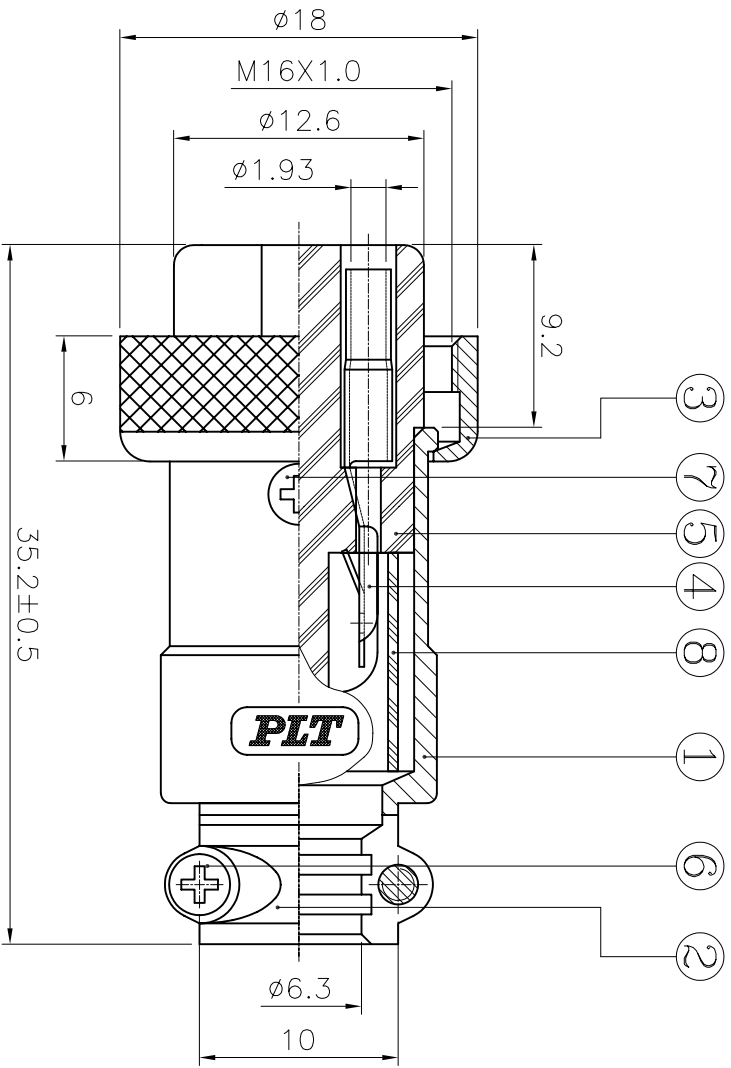
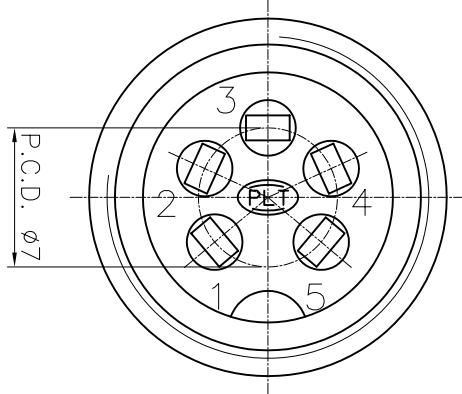

B-317ZN 後視圖

NO.	ELECTRICAL CHARACTERISTICS
1	Rated Current/voltage 5A 125V
2	Operation limit voltage (AC.V.rms) 200
3	Withstanding voltage (AC.V.rms) 1 minute 1000
4	Insulation resistance(MΩ MIN.) at DC 500V 1000
5	Contact resistance (mΩ MAX.) at DC 1A 20

ISO-9001:2000 CERTIFIED MANUFACTURER		ALUMINUM PRECISION TECHNOLOGY CORP.	
APEX PRECISION TECHNOLOGY CORP.		ALUMINUM PRECISION TECHNOLOGY CORP.	
機種 MODEL	名稱 NAME	日期 DATE	公差 TOLERANCE
PLT-165-P-R	5 PIN CONNECTOR RoHS	2005.12.21	±0.2
單位 UNIT	比例 SCALE	DESIGNER	CHECKED
mm	2.5 X	開發部 2005.12.21 Jiew	審核
圖形	比例	設計	批准
APPROVE			