

## PLUG TYPE 5.5 × 2.1 & 5.5 × 2.5

**No.MP-121M**  
5.5 × 2.1 DC PLUG (DC12V 0.5A)  
**No.MP-122M**  
5.5 × 2.5 DC PLUG (DC12V 1A)

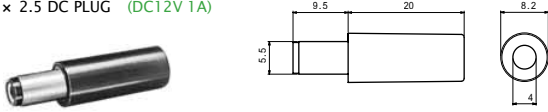

**No.MP-121C**  
5.5 × 2.1 DC PLUG (DC12V 0.5A)  
**No.MP-122C**  
5.5 × 2.5 DC PLUG (DC12V 1A)

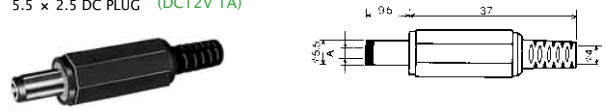

**No.MP-136**  
5.5 × 2.1 LONG TYPE DC PLUG (DC12V 0.5A)  
**No.MP-137**  
5.5 × 2.5 LONG TYPE DC PLUG (DC12V 1A)

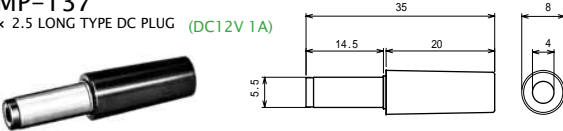

**No.MP-136H**  
5.5 × 2.1 LONG TYPE DC PLUG (DC12V 0.5A)  
**No.MP-137H**  
5.5 × 2.5 LONG TYPE DC PLUG (DC12V 1A)

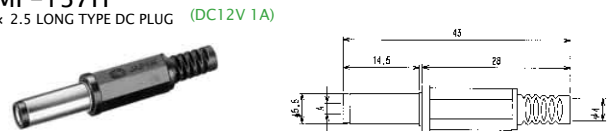

**RIGHT ANGLE DC PLUG**  
**No.MP-136LN** (DC12V 0.5A)  
5.5 × 2.1 DC PLUG  
**No.MP-137LN** (DC12V 1A)  
5.5 × 2.5 DC PLUG

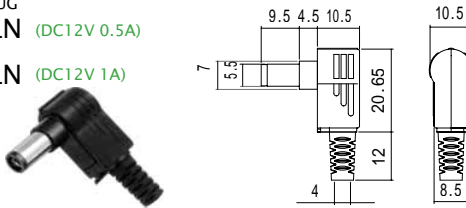

**DC ADAPTOR CABLE L=1800mm**  
**No.MC-2374** (DC12V 0.5A)  
5.5 × 2.1 DC PLUG  
**No.MC-2375** (DC12V 1A)  
5.5 × 2.5 DC PLUG



**DC JACK FOR P.C.B.**  
**No.MJ-179P**  
PLUG TYPE: 5.5 × 2.1 (DC12V 0.5A)  
**No.MJ-180P**  
PLUG TYPE: 5.5 × 2.5 (DC12V 1A)

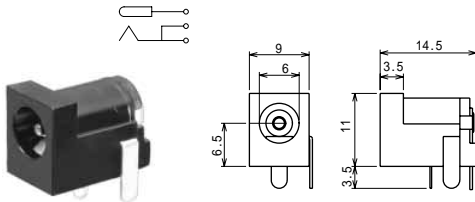

**DC ADAPTOR CABLE L=1800mm**  
**No.MC-2374L** (DC12V 0.5A)  
5.5 × 2.1 DC PLUG  
**No.MC-2375L** (DC12V 1A)  
5.5 × 2.5 DC PLUG



**DC JACK FOR P.C.B. SMT**  
**No.MJ-179SMT**  
PLUG TYPE: 5.5 × 2.1 (DC12V 0.5A)  
**No.MJ-180SMT**  
PLUG TYPE: 5.5 × 2.5 (DC12V 1A)

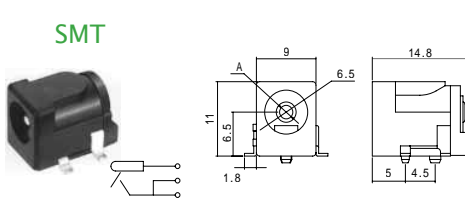

**DC JACK FOR P.C.B.**  
**No.MJ-196P**  
PLUG TYPE: 5.5 × 2.1 (DC12V 0.5A)  
**No.MJ-197P**  
PLUG TYPE: 5.5 × 2.5 (DC12V 1A)

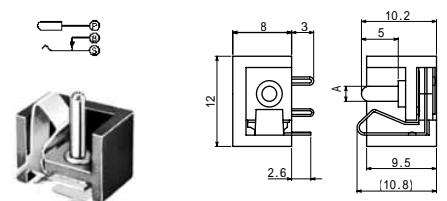

**DC JACK FOR P.C.B.**  
**No.MJ-179LE**  
PLUG TYPE: 5.5 × 2.1 (DC12V 0.5A)  
**No.MJ-180LE**  
PLUG TYPE: 5.5 × 2.5 (DC12V 1A)

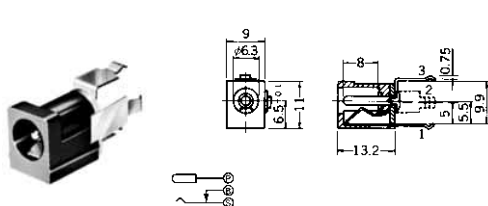

**No.MJ-292DJ**  
DC JACK FOR P.C.B.  
PLUG TYPE: 5.5 × 2.1 (DC12V 0.5A)

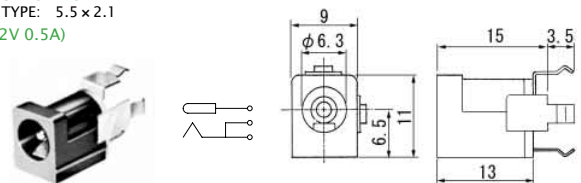

**No.MJ-272DJ**  
DC JACK FOR P.C.B.  
PLUG TYPE: 5.5 × 2.1 (DC12V 0.5A)

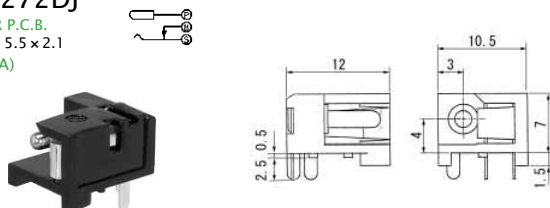

## PLUG TYPE 5.5 × 2.1 & 5.5 × 2.5

### PANEL MOUNT DC JACK

**No.MJ-10**

PLUG TYPE: 5.5 × 2.1  
(DC12V 0.5A)

**No.MJ-11**

PLUG TYPE: 5.5 × 2.5  
(DC12V 1A)

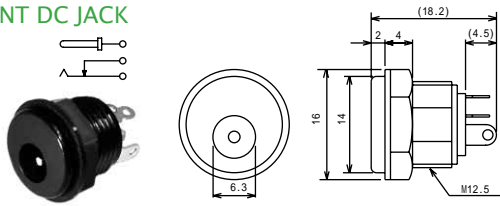

### PANEL MOUNT DC JACK

**No.MJ-14**

PLUG TYPE: 5.5 × 2.1  
(DC12V 0.5A)

**No.MJ-15**

PLUG TYPE: 5.5 × 2.5  
(DC12V 1A)

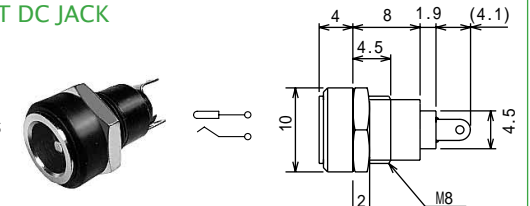

### PANEL MOUNT DC JACK

**No.MJ-40**

PLUG TYPE: 5.5 × 2.1  
(DC12V 0.5A)

**No.MJ-41**

PLUG TYPE: 5.5 × 2.5  
(DC12V 1A)

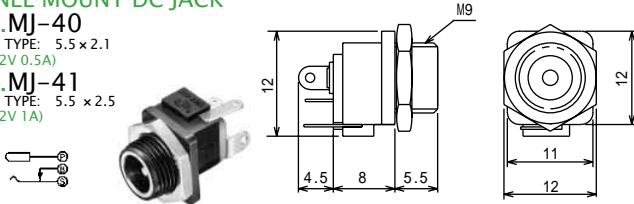

### PANEL MOUNT DC JACK

**No.MJ-70**

PLUG TYPE: 5.5 × 2.1  
(DC12V 0.5A)

**No.MJ-71**

PLUG TYPE: 5.5 × 2.5  
(DC12V 1A)

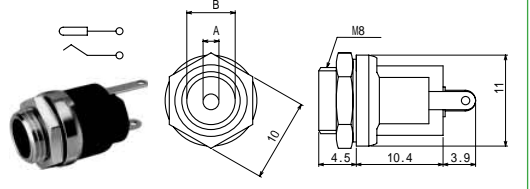

### SNAP-IN MOUNT DC JACK

スナップインDCジャック

**No.MJ-60**

PLUG TYPE: 5.5 × 2.1  
(DC12V 0.5A)

**No.MJ-61**

PLUG TYPE: 5.5 × 2.5  
(DC12V 1A)

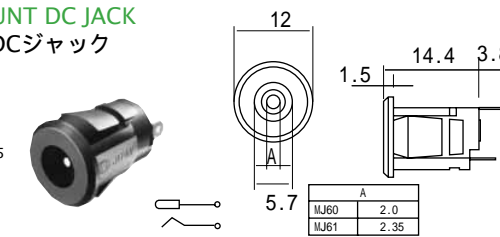

### PANEL MOUNT DC JACK

**No.MJ-179**

PLUG TYPE: 5.5 × 2.1  
(DC12V 0.5A)

**No.MJ-180**

PLUG TYPE: 5.5 × 2.5  
(DC12V 1A)

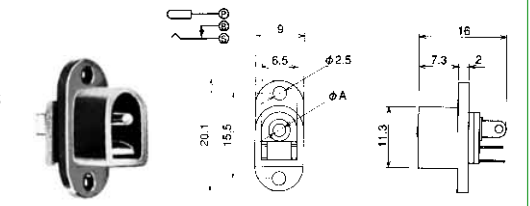

### PANEL MOUNT DC JACK

**No.MJ-181M**

PLUG TYPE: 5.5 × 2.1  
(DC12V 0.5A)

**No.MJ-182M**

PLUG TYPE: 5.5 × 2.5  
(DC12V 1A)

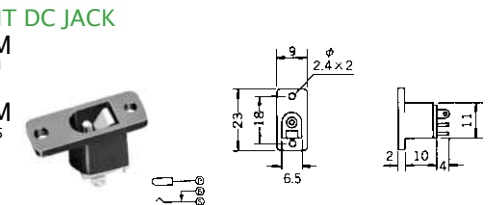

### PANEL MOUNT DC JACK (SCREW TYPE)

**No.MJ-181MS**

PLUG TYPE: 5.5 × 2.1  
(DC12V 0.5A)

**No.MJ-182MS**

PLUG TYPE: 5.5 × 2.5  
(DC12V 1A)

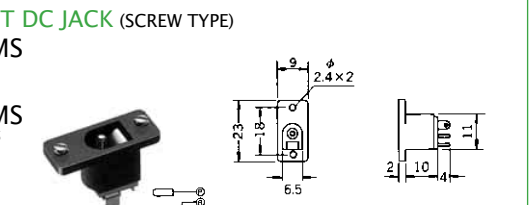

### DC JACK INSERT TYPE

**No.MJ-196**

PLUG TYPE: 5.5 × 2.1  
(DC12V 0.5A)

**No.MJ-197**

PLUG TYPE: 5.5 × 2.5  
(DC12V 1A)

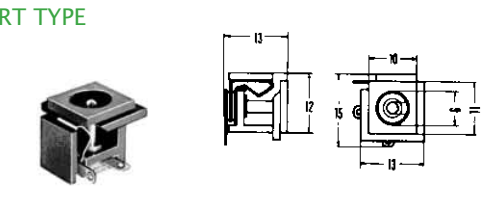

### DC JACK INSERT TYPE

**No.MJ-196E**

PLUG TYPE: 5.5 × 2.1  
(DC12V 0.5A)

**No.MJ-197E**

PLUG TYPE: 5.5 × 2.5  
(DC12V 1A)

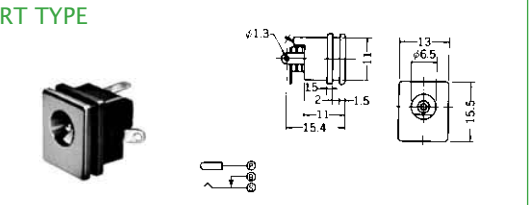

### PANEL MOUNT DC JACK

**No.MJ-21**

PLUG TYPE: 5.5 × 2.1  
(DC12V 0.5A)

**No.MJ-22**

PLUG TYPE: 5.5 × 2.5  
(DC12V 1A)

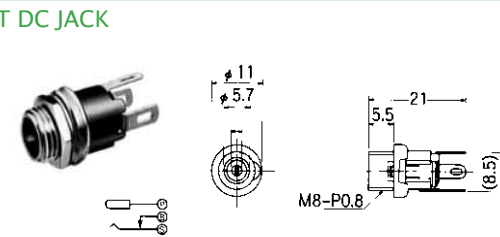

### PANEL MOUNT DC JACK

**No.MJ-21AM**

PLUG TYPE: 5.5 × 2.1  
(DC12V 0.5A)

**No.MJ-22AM**

PLUG TYPE: 5.5 × 2.5  
(DC12V 1A)

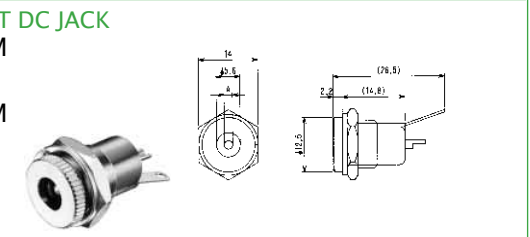

### DC INLINE JACK

**No.MJ-077N**

PLUG TYPE: 5.5 × 2.1  
(DC12V 0.5A)

**No.MJ-078N**

PLUG TYPE: 5.5 × 2.5  
(DC12V 1A)

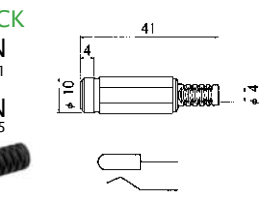

### DC EXTENSION CABLE L=1800mm

**No.MC-2376**

PLUG TYPE: 5.5 × 2.1  
(DC12V 0.5A)

**No.MC-2377**

PLUG TYPE: 5.5 × 2.5  
(DC12V 1A)



### DC INLINE JACK FOR MOLDING

**No.MJ-23**

PLUG TYPE: 5.5 × 2.1  
(DC12V 0.5A)

**No.MJ-24**

PLUG TYPE: 5.5 × 2.5  
(DC12V 1A)

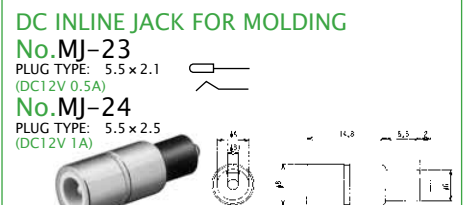

### DCプラグ変換アダプター (ストレート L型)

DC PLUG ADAPTOR STRAIGHT PLUG TO RIGHT ANGLE PLUG

**No.MA-121SL**

PLUG TYPE: 5.5 × 2.1用

**No.MA-122SL**

PLUG TYPE: 5.5 × 2.5用

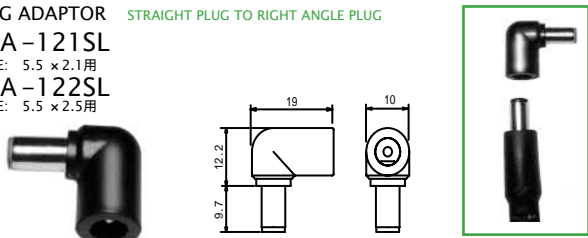

### DC CENTIPEDE POWER CABLE

**No.MC-1J3P**

1 JACK 3 PLUGS (5.5 × 2.1mm)  
(DC12V 0.5A)

**No.MC-1J5P**

1 JACK 5 PLUGS (5.5 × 2.1mm)



Other combinations are available upon request.