

## PLUG TYPE 3.4 × 1.4

**No.MP-121WK**  
3.4 × 1.4 DC PLUG  
(DC12V 0.5A)

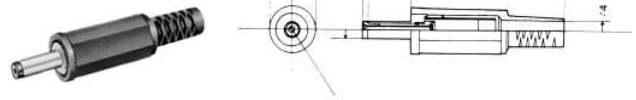

**No.MP-121WH**  
3.4 × 1.4 DC PLUG  
(DC12V 0.5A)



**No.MP-121WN**  
3.4 × 1.4 RIGHT ANGLE DC PLUG  
(DC12V 0.5A)

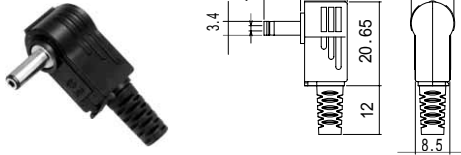

**No.MJ-82-1**  
DC JACK FOR P.C.B.  
PLUG TYPE: 3.4 × 1.4  
(DC6V 0.5A)

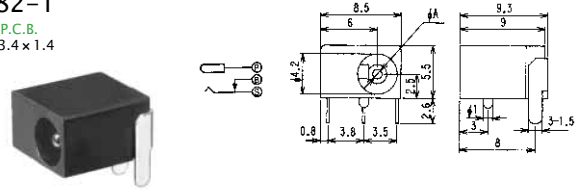

**No.MJ-83**  
DC JACK FOR P.C.B.  
PLUG TYPE: 3.4 × 1.4  
(DC6V 0.5A)

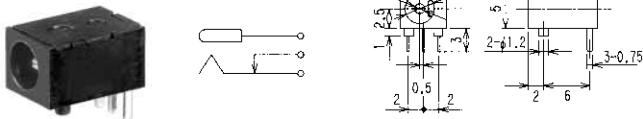

**No.MJ-84**  
DC JACK FOR P.C.B.  
PLUG TYPE: 3.4 × 1.4  
(DC6V 0.5A)

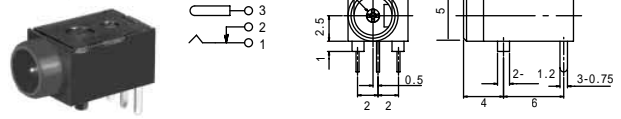

**No.MJ-25N1**  
DC JACK FOR P.C.B.  
PLUG TYPE: 3.4 × 1.4  
(DC6V 0.5A)

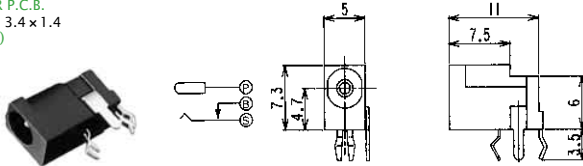

**No.MJ-44**  
PANEL MOUNT DC JACK  
PLUG TYPE: 3.4 × 1.4  
(DC12V 0.5A)

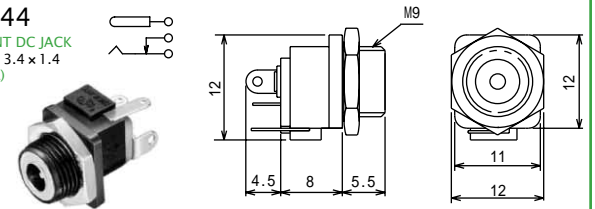

**No.MJ-441DJ**  
DC JACK FOR P.C.B.  
PLUG TYPE: 3.4 × 1.4  
(DC6V 0.5A)

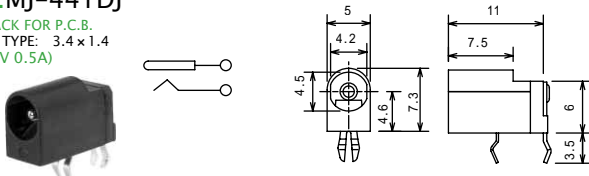

**No.MJ-74**  
PANEL MOUNT DC JACK  
PLUG TYPE: 3.4 × 1.4  
(DC12V 0.5A)

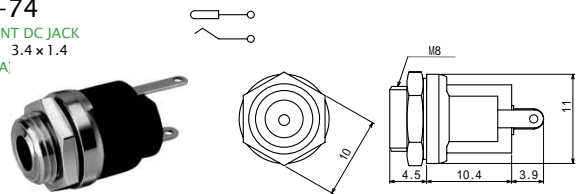

**No.MJ-99**  
PANEL MOUNT DC JACK  
PLUG TYPE: 3.4 × 1.4  
(DC12V 0.5A)

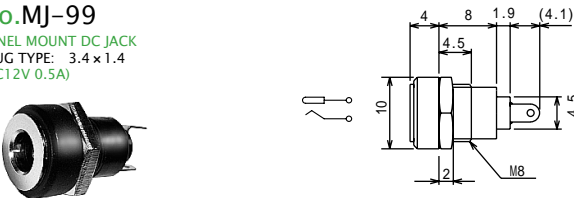

**No.MJ-099N**  
DC INLINE JACK  
PLUG TYPE: 3.4 × 1.4  
(DC12V 0.5A)

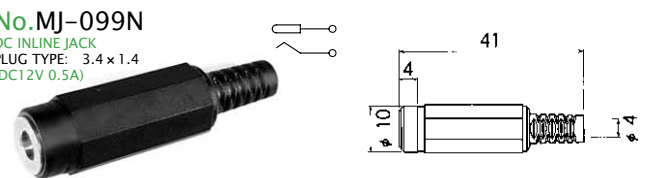

## PLUG TYPE 3.8 × 1.4

**No.MP-138NK**  
3.8 × 1.4 DC PLUG  
(DC12V 0.5A)

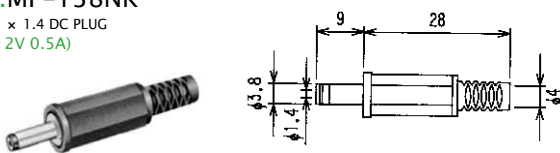

**No.MJ-45**  
PANEL MOUNT DC JACK  
PLUG TYPE: 3.8 × 1.4  
(DC12V 0.5A)

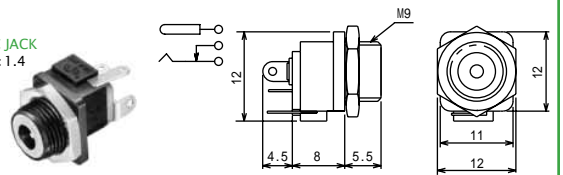

**No.MJ-99/3.8**  
PANEL MOUNT DC JACK  
PLUG TYPE: 3.8 × 1.4  
(DC12V 0.5A)

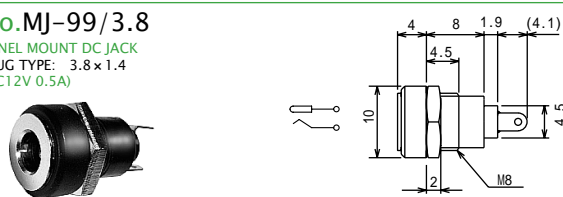

**No.MJ-75**  
PANEL MOUNT DC JACK  
PLUG TYPE: 3.8 × 1.4  
(DC12V 0.5A)

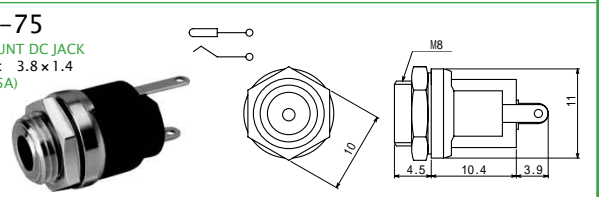

**No.MJ-099N/3.8**  
DC INLINE JACK  
PLUG TYPE: 3.8 × 1.4  
(DC12V 0.5A)

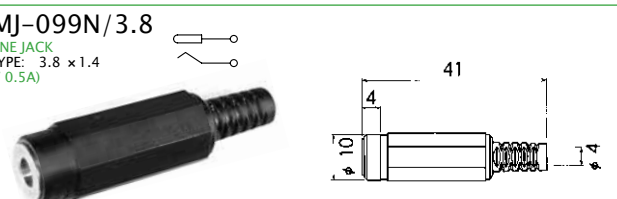

## PLUG TYPE 3.0 × 1.0

**No.MP-121PS**  
3.0 × 1.1 DC PLUG  
(DC12V 0.5A)

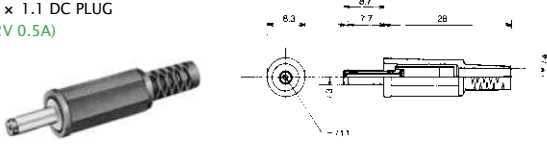

**No.MP-121PN**  
3.0 × 1.1 RIGHT ANGLE DC PLUG  
(DC12V 0.5A)

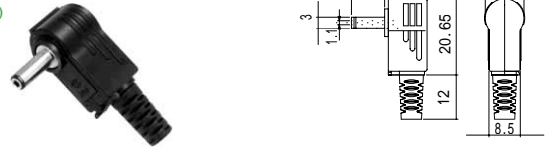

**No.MJ-25N**  
DC JACK FOR P.C.B.  
PLUG TYPE: 3.0 × 1.1  
(DC6V 0.5A)

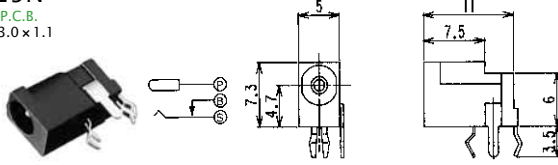

**No.MJ-82-2**  
DC JACK FOR P.C.B.  
PLUG TYPE: 3.0 × 1.1  
(DC6V 0.5A)

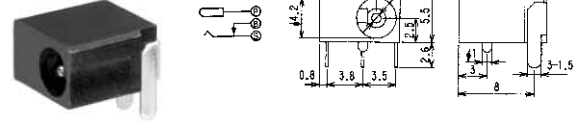

**No.MJ-442DJ**  
DC JACK FOR P.C.B.  
PLUG TYPE: 3.0 × 1.1  
(DC6V 0.5A)

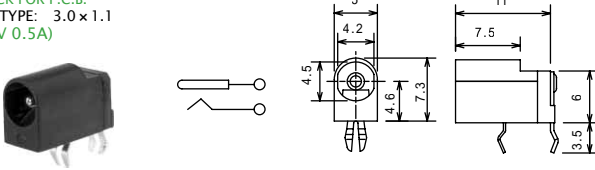

## PLUG TYPE 3.5 × 1.1

**No.MP-135NK**  
3.5 × 1.1 DC PLUG  
(DC12V 0.5A)

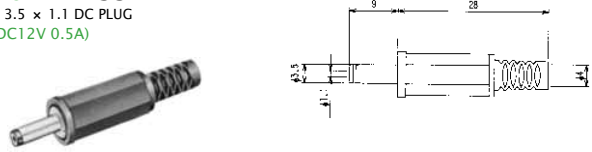

## PLUG TYPE 7.5 × 4.1 (CENTER PIN 1)

**No.MP-139SF**  
7.5 × 4.1 (CENTER PIN: 1) DC PLUG  
(DC12V 2A)

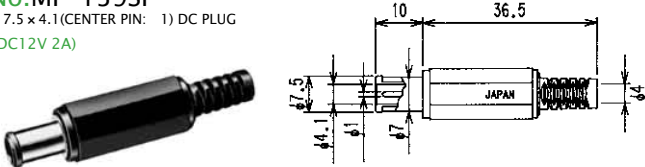

## PLUG TYPE 6.3 × 3.1

**No.MP-065L**  
6.3 × 3.1 DC PLUG  
(DC12V 2A)



**No.MJ-065M**  
PANEL MOUNT DC JACK  
PLUG TYPE: 6.3 × 3.1  
(DC12V 2A)

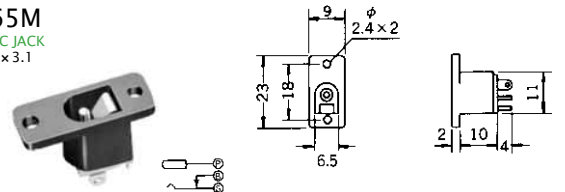

## LOCKABLE DC PLUGS & JACKS

## ロック式DCプラグ&ジャック

### LOCKABLE DC JACK FOR PANEL MOUNT

**No.MJ-10LR**  
TO MATE WITH MP-121AR  
MP-121MR & MC1210LR  
(DC12V 0.5A)

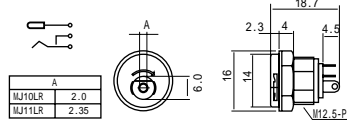

**No.MJ-11LR**  
TO MATE WITH MP-122AR  
MP-122MR & MC1220LR  
(DC12V 1A)

	A
MJ10LR	2.0
MJ11LR	2.35

### LOCKABLE DC SOCKET FOR P.C.B.

**No.MJ-179LR**  
TO MATE WITH MP-121AR  
MP-121MR & MC1210LR  
(DC12V 0.5A)

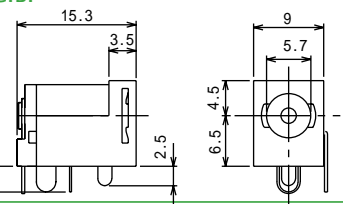

**No.MJ-180LR**  
TO MATE WITH MP-122AR  
MP-122MR & MC1220LR  
(DC12V 1A)

### DC-PLUG WITH LOCKING DETENT

**No.MP-121LL**  
TO MATE WITH MJ-179R & MJ-10LR  
(DC12V 0.5A)

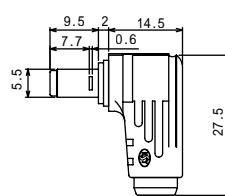

**No.MP-122LL**  
TO MATE WITH MJ-180LR & MJ-11LR  
(DC12V 1A)

### DC-PLUG WITH LOCKING DETENT

**No.MP-121AR**  
TO MATE WITH MJ-179R & MJ-10LR  
(DC12V 0.5A)

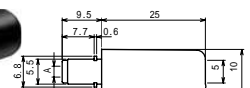

**No.MP-122AR**  
TO MATE WITH MJ-180LR & MJ-11LR  
(DC12V 1A)

### DC ADAPTER CABLE FOR LOCKABLE DC JACK

ロック式DCジャック専用DCプラグ付ケーブル L=1800

**No.MC-1210LR**

TO MATE WITH MJ-179LR & MJ-10LR  
(DC12V 0.5A)

**No.MC-1220LR**

TO MATE WITH MJ-180LR & MJ-11LR  
(DC12V 1A)



### DC-PLUG WITH LOCKING DETENT FOR MOLDING

**No.MP-121MR**  
TO MATE WITH MJ-179R & MJ-10LR  
(DC12V 0.5A)

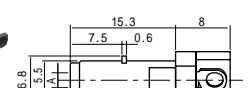

**No.MP-122MR**  
TO MATE WITH MJ-180LR & MJ-11LR  
(DC12V 1A)



# DC PLUGS & JACKS

## EIAJ RC5321

JACK FOR LOW VOLTAGE DC POWER SUPPLY OUTPUT AND MATING PLUG  
DC電源出力用プラグ・ジャック 電圧区分4 適合品  
TYPE4

RATING 定 格 : DC13.5V 2A

### No.MP-214

EIAJ RC-5321 CLASS4 電圧区分4  
(DC13.5V 2A)

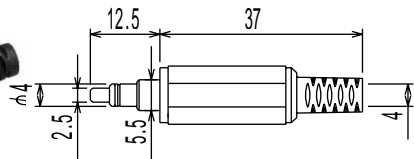

### No.M04-510DJ

DC JACK FOR P.C.B.  
EIAJ RC-5321 CLASS4 電圧区分4  
(DC13.5V 2A)

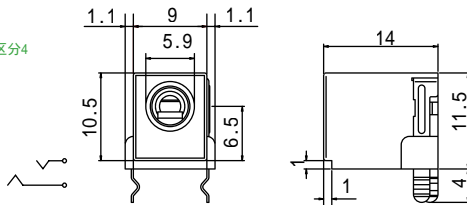

## EIAJ RC5322

TO ELECTRONIC EQUIPMENT USED IN A CAR

車載機器用 RATING 定 格 : DC24V 2A

### No.MP-206

6.5 × 3.1 (center pin : 1.0 ) DC PLUG  
(DC24V 2A)

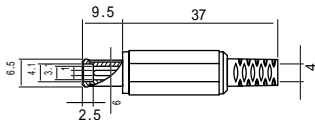

### No.MJ-300J

DC JACK FOR P.C.B.  
PLUG TYPE: 6.5 × 3.1 (center pin : 1.0 )  
(DC24V 2A)

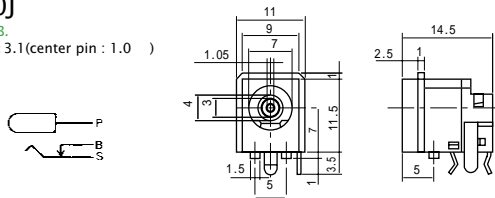

Marushin electric mfg. co., Ltd.